

## COMEUP Seal Gen2 9.5s Self Recovery Vehicle Winch With Synthetic Rope



- Hawse fairlead
- Remote control w/5 m (17') cord
- Detachable control box
- Synthetic rope w/sling hook
- 1.8 m (6') 2 gauge battery lead
- Handsaver strap



Telephone: +44 (0)1482 620991  
Email: [sales@winchsystems.co.uk](mailto:sales@winchsystems.co.uk)  
Web: [www.winchsystems.co.uk](http://www.winchsystems.co.uk)

- 12V DC severe duty winch rated at 9,500 lb pulling meets or exceeds your expectations.
- Heavy duty series wound motor equipped with thermal switch alters when motor over-heating.
- 16 equally positioned pin holes with an ergonomic T-handle make it possible to reposition in 22.5 degree increments.
- Water-proof remote control with thermometric LED indicator w/5 m cord
- A 12 strand construction synthetic rope coated to improve abrasion and has no water absorption.
- Tough aluminum die cast housings withstand strength of 2.0 x rated load of winch
- The U.S. Germany, U.K. France, etc patented mechanical cone brake outside the drum expedites heat dispersion and also makes the winch ideal for use with synthetic rope.
- Meet SAE J706, CE Machinery Directive 2006/42/EC and CE





## Specification/Part Numbers

- Part number: PN 295990
- Rated line pull: 4,309 kg / 9,500 lb single line
- Motor: 3,730 w / 5.0 hp 12V series wound
- Gear ratio : 3-stage planetary 159:1
- Clutch (freespooling): Rotating ring gear
- Brake (outside the drum): Automatic, full load CBS (Cone Brake Structure)
- Winch construction: Aluminum die cast housings with steel drum
- Drum size: 63.5 mm x 227L mm (2.5" x 8.9"L)
- Control: Waterproof remote with thermometric indicator LED w/ 5 m (17') cord
- Rope type: Synthetic rope
- Rope size: 10 mm x 30.5 m (3/8" x 100')
- Mounting bolt pattern: 254 mm x 114 mm (10" x 4.5")
- Mounting : Foot forward or foot down mounting workable
- Finish : Matte black powder-coated
- Winch weight (including rope) : 28.5 kg / 62.5 lb
- Gross weight : 40 kg / 88 lb
- Box dimension, (L x D x H) : 682 x 209 x 430 mm (26.9" x 8.2" x 16.9")

## Line Speed and Amp. Draw (1st layer of wire rope on the drum):

Line Pull, kg / lb	Line Speed, mpm / fpm	Amp. Draw, A
		12V
No load	14.8 / 48.6	60
907 / 2,000	4.8 / 15.7	115
1,814 / 4,000	3.6 / 11.8	210
2,722 / 6,000	2.8 / 9.2	245
3,629 / 8,000	2.3 / 7.6	280
4,309 / 9,500	2.2 / 7.2	380

## Line Pull and Rope Capacity:

Layer of Rope	Pull by layer, kg / lb	Total Rope on the Drum, m / ft
1 <sup>st</sup>	4,309 / 9,500	5.1 / 16.7
2 <sup>nd</sup>	3,472 / 7,655	11.7 / 38.4
3 <sup>rd</sup>	2,908 / 6,410	19.7 / 64.6
4 <sup>th</sup>	2,501 / 5,514	30.5 / 100

### Warning

**Winches are not to be used for the lifting or moving of persons.**  
**The rated line pull shown is based on the first layer of rope on the drum.**  
**The rope winding on the drum shall remain 10 wraps from the drum.**



Telephone: +44 (0)1482 620991  
Email: sales@winchsystems.co.uk  
Web: www.winchsystems.co.uk



## Dimension, mm/in:

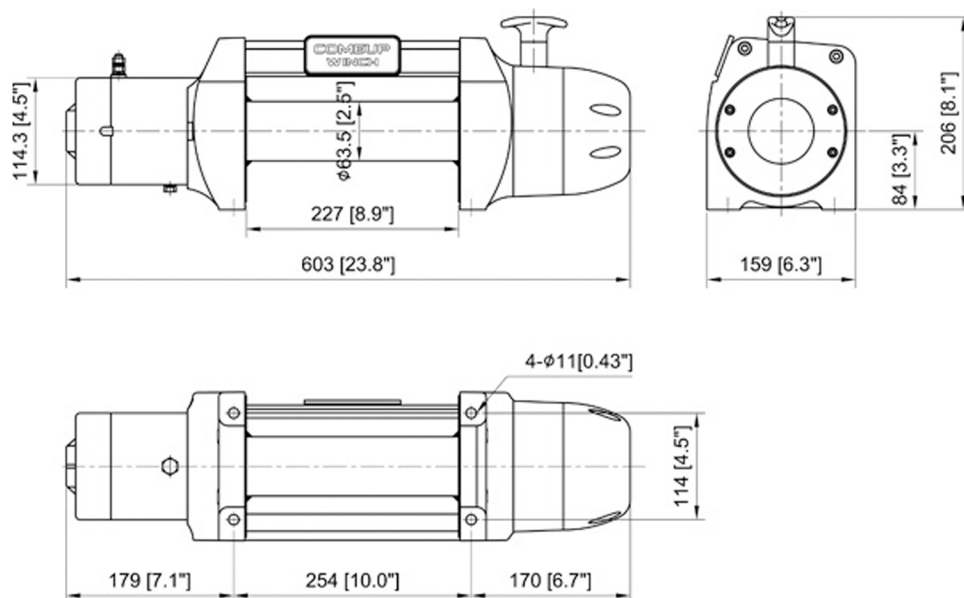

16 equally positioned pin holes ensure seamless clutch transmission and make it easily rotate by  $22.5^\circ$  increments.

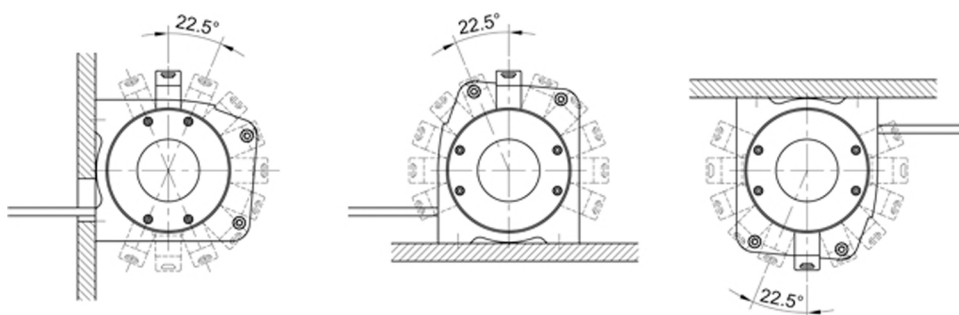

## Warranty

Each new winch is guaranteed against defects in workmanship and material defects for a stipulate period from date of purchase.

**\*Automotive Winch:** Limited lifetime warranty for mechanical components,  
**New Seal Gen2 Series winch** a three (3) years warranty for electrical components,  
**WIRE/SYNTHETIC ROPES ARE NOT INCLUDED UNDER WARRANTY.**



Telephone: +44 (0)1482 620991  
Email: sales@winchsystems.co.uk  
Web: www.winchsystems.co.uk